

# ART. 044

## SIDE SAMPLING VALVES

### 90° O-RING SAMPLING VALVES



**Characteristics:** Designed for sampling of liquids on pharmaceutical, chemical, F&B and cosmetics products. O-Ring closing system.

**Documentation:** Laser marking for traceability and validation processes. Material 3.1 certificates, FDA or USP, internal surface finishing check as standard.

#### 1 HOSE BARB OUTLET

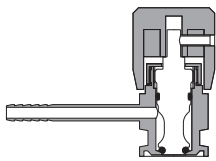

**ART. 044/A**  
P. 133

#### 1 TRI-CLAMP OUTLET

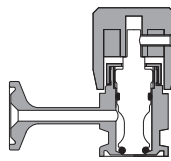

**ART. 044/B**  
P. 136

#### 1 HOSE BARB OUTLET + 1 CIP HOSE BARB INLET

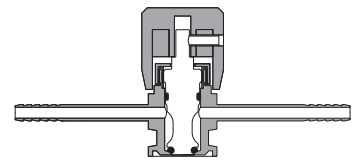

**ART. 044/C**  
P. 139

#### 1 HOSE BARB OUTLET + 1 CIP TRI-CLAMP INLET

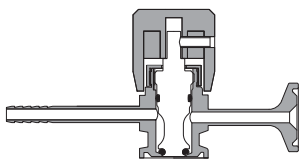

**ART. 044/D**  
P. 142

#### 1 TRI-CLAMP OUTLET + 1 CIP TRI-CLAMP INLET

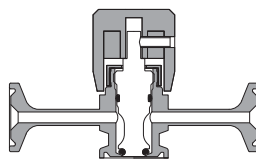

**ART. 044/E**  
P. 145

#### 1 TRI-CLAMP OUTLET + 1 CIP/SIP TRI-CLAMP INLET + REMOVABLE HANDLE

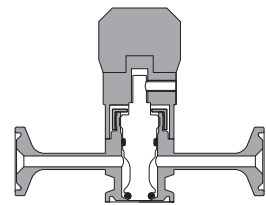

**ART. 044/F**  
P. 148

ASTM A270 Tri-Clamp - Flange design according to ASME-BPE 2009

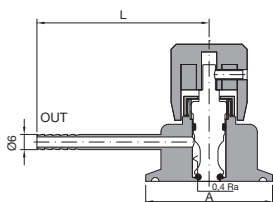
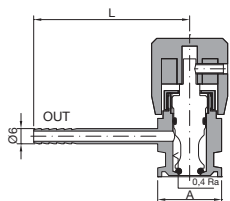

Int. finishing:  $Ra \leq 0,4 \mu m$   
Ext. finishing:  $Ra \leq 0,8 \mu m$  Mirror Polished

Max Working Conditions:  
**12 bar (170 psi) and 150°C (300°F)**

Installation:  
**Horizontal installation recommended**

Size	Ø A	L	Valve Material	O-Rings Material	Code
1/2"	25,00	61,50	1.4404	FPM/FKM	<b>044A60050V</b>
				EPDM	<b>044A60050EP</b>
				SILICONE FDA	<b>044A60050SIF</b>
				SILICONE USP-121	<b>044A60050SH121</b>
			1.4435-BN2	FPM/FKM	<b>044A50050V</b>
				EPDM	<b>044A50050EP</b>
				SILICONE FDA	<b>044A50050SIF</b>
				SILICONE USP-121	<b>044A50050SH121</b>
3/4"	25,00	61,50	1.4404	FPM/FKM	<b>044A60075V</b>
				EPDM	<b>044A60075EP</b>
				SILICONE FDA	<b>044A60075SIF</b>
				SILICONE USP-121	<b>044A60075SH121</b>
			1.4435-BN2	FPM/FKM	<b>044A50075V</b>
				EPDM	<b>044A50075EP</b>
				SILICONE FDA	<b>044A50075SIF</b>
				SILICONE USP-121	<b>044A50075SH121</b>
1"	50,40	68,00	1.4404	FPM/FKM	<b>044A60100V</b>
				EPDM	<b>044A60100EP</b>
				SILICONE FDA	<b>044A60100SIF</b>
				SILICONE USP-121	<b>044A60100SH121</b>
			1.4435-BN2	FPM/FKM	<b>044A50100V</b>
				EPDM	<b>044A50100EP</b>
				SILICONE FDA	<b>044A50100SIF</b>
				SILICONE USP-121	<b>044A50100SH121</b>
1.1/2"	50,40	68,00	1.4404	FPM/FKM	<b>044A60150V</b>
				EPDM	<b>044A60150EP</b>
				SILICONE FDA	<b>044A60150SIF</b>
				SILICONE USP-121	<b>044A60150SH121</b>
			1.4435-BN2	FPM/FKM	<b>044A50150V</b>
				EPDM	<b>044A50150EP</b>
				SILICONE FDA	<b>044A50150SIF</b>
				SILICONE USP-121	<b>044A50150SH121</b>

Part list

ASTM A270: Ø A 25	DIN / ISO: Ø A 34	ASTM A270 / DIN / ISO: Ø A 50	N°	Name	Material
			1	Body	AISI 316L
			2	O-Ring 3021	FPM/FKM or EPDM or SILICONE
			3	Piston	AISI 316L
			4	O-Ring 2037	FPM/FKM or EPDM or SILICONE
			5	Ring	AISI 316L
			6	Grub Screw M4	AISI 304
			7	Handle	PTFE + INOX

DIN 32676 - Trl-Clamp

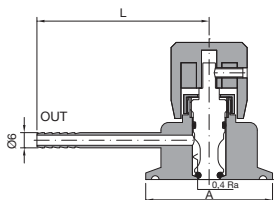
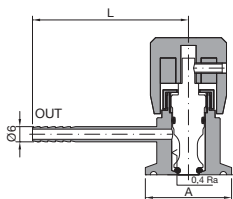

Size	Ø A	L	Valve Material	O-Rings Material	Code
DN 10	34,00	61,50	1.4404	FPM/FKM	044A6D010V
				EPDM	044A6D010EP
				SILICONE FDA	044A6D010SIF
				SILICONE USP-121	044A6D010SI121
			1.4435-BN2	FPM/FKM	044A5D010V
				EPDM	044A5D010EP
				SILICONE FDA	044A5D010SIF
				SILICONE USP-121	044A5D010SI121
DN 15	34,00	61,50	1.4404	FPM/FKM	044A6D015V
				EPDM	044A6D015EP
				SILICONE FDA	044A6D015SIF
				SILICONE USP-121	044A6D015SI121
			1.4435-BN2	FPM/FKM	044A5D015V
				EPDM	044A5D015EP
				SILICONE FDA	044A5D015SIF
				SILICONE USP-121	044A5D015SI121
DN 20	34,00	61,50	1.4404	FPM/FKM	044A6D020V
				EPDM	044A6D020EP
				SILICONE FDA	044A6D020SIF
				SILICONE USP-121	044A6D020SI121
			1.4435-BN2	FPM/FKM	044A5D020V
				EPDM	044A5D020EP
				SILICONE FDA	044A5D020SIF
				SILICONE USP-121	044A5D020SI121
DN 25	50,50	68,00	1.4404	FPM/FKM	044A6D025V
				EPDM	044A6D025EP
				SILICONE FDA	044A6D025SIF
				SILICONE USP-121	044A6D025SI121
			1.4435-BN2	FPM/FKM	044A5D025V
				EPDM	044A5D025EP
				SILICONE FDA	044A5D025SIF
				SILICONE USP-121	044A5D025SI121
DN 32	50,50	68,00	1.4404	FPM/FKM	044A6D032V
				EPDM	044A6D032EP
				SILICONE FDA	044A6D032SIF
				SILICONE USP-121	044A6D032SI121
			1.4435-BN2	FPM/FKM	044A5D032V
				EPDM	044A5D032EP
				SILICONE FDA	044A5D032SIF
				SILICONE USP-121	044A5D032SI121
DN 40	50,50	68,00	1.4404	FPM/FKM	044A6D040V
				EPDM	044A6D040EP
				SILICONE FDA	044A6D040SIF
				SILICONE USP-121	044A6D040SI121
			1.4435-BN2	FPM/FKM	044A5D040V
				EPDM	044A5D040EP
				SILICONE FDA	044A5D040SIF
				SILICONE USP-121	044A5D040SI121

Int. finishing: **Ra ≤ 0,4 µm**  
Ext. finishing: **Ra ≤ 0,8 µm Mirror Polished**

Max Working Conditions:  
**12 bar (170 psi) and 150°C (300°F)**

Installation:  
**Horizontal installation recommended**

ISO 1127 Tri-Clamp

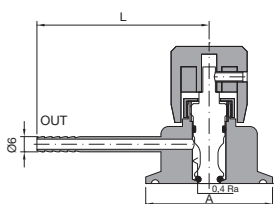
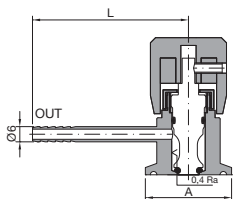

Size	Ø A	L	Valve Material	O-Rings Material	Code
DN 8	34,00	61,50	1.4404	FPM/FKM	044A61008V
				EPDM	044A61008EP
				SILICONE FDA	044A61008SIF
				SILICONE USP-121	044A61008SI121
			1.4435-BN2	FPM/FKM	044A51008V
				EPDM	044A51008EP
				SILICONE FDA	044A51008SIF
				SILICONE USP-121	044A51008SI121
DN 10	34,00	61,50	1.4404	FPM/FKM	044A61010V
				EPDM	044A61010EP
				SILICONE FDA	044A61010SIF
				SILICONE USP-121	044A61010SI121
			1.4435-BN2	FPM/FKM	044A51010V
				EPDM	044A51010EP
				SILICONE FDA	044A51010SIF
				SILICONE USP-121	044A51010SI121
DN 15	34,00	61,50	1.4404	FPM/FKM	044A61015V
				EPDM	044A61015EP
				SILICONE FDA	044A61015SIF
				SILICONE USP-121	044A61015SI121
			1.4435-BN2	FPM/FKM	044A51015V
				EPDM	044A51015EP
				SILICONE FDA	044A51015SIF
				SILICONE USP-121	044A51015SI121
DN 20	50,50	68,00	1.4404	FPM/FKM	044A61020V
				EPDM	044A61020EP
				SILICONE FDA	044A61020SIF
				SILICONE USP-121	044A61020SI121
			1.4435-BN2	FPM/FKM	044A51020V
				EPDM	044A51020EP
				SILICONE FDA	044A51020SIF
				SILICONE USP-121	044A51020SI121
DN 25	50,50	68,00	1.4404	FPM/FKM	044A61025V
				EPDM	044A61025EP
				SILICONE FDA	044A61025SIF
				SILICONE USP-121	044A61025SI121
			1.4435-BN2	FPM/FKM	044A51025V
				EPDM	044A51025EP
				SILICONE FDA	044A51025SIF
				SILICONE USP-121	044A51025SI121
DN 32	50,50	68,00	1.4404	FPM/FKM	044A61032V
				EPDM	044A61032EP
				SILICONE FDA	044A61032SIF
				SILICONE USP-121	044A61032SI121
			1.4435-BN2	FPM/FKM	044A51032V
				EPDM	044A51032EP
				SILICONE FDA	044A51032SIF
				SILICONE USP-121	044A51032SI121

Int. finishing: **Ra ≤ 0,4 µm**  
Ext. finishing: **Ra ≤ 0,8 µm Mirror Polished**

Max Working Conditions:  
**12 bar (170 psi) and 150°C (300°F)**

Installation:  
**Horizontal installation recommended**

ASTM A270 Tri-Clamp - Flange design according to ASME-BPE 2009

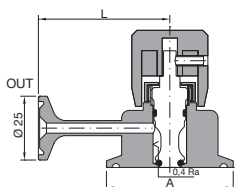
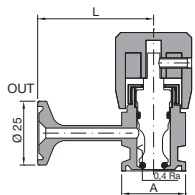

Int. finishing: **Ra ≤ 0,4 µm**  
 Ext. finishing: **Ra ≤ 0,8 µm Mirror Polished**  
 Max Working Conditions:  
**12 bar (170 psi) and 150°C (300°F)**  
 Installation:  
**Horizontal installation recommended**

Size	Ø A	L	Valve Material	O-Rings Material	Code
1/2"	25,00	51,50	1.4404	FPM/FKM	<b>044B60050V</b>
				EPDM	<b>044B60050EP</b>
				SILICONE FDA	<b>044B60050SIF</b>
				SILICONE USP-121	<b>044B60050SI121</b>
			1.4435-BN2	FPM/FKM	<b>044B50050V</b>
				EPDM	<b>044B50050EP</b>
				SILICONE FDA	<b>044B50050SIF</b>
				SILICONE USP-121	<b>044B50050SI121</b>
3/4"	25,00	51,50	1.4404	FPM/FKM	<b>044B60075V</b>
				EPDM	<b>044B60075EP</b>
				SILICONE FDA	<b>044B60075SIF</b>
				SILICONE USP-121	<b>044B60075SI121</b>
			1.4435-BN2	FPM/FKM	<b>044B50075V</b>
				EPDM	<b>044B50075EP</b>
				SILICONE FDA	<b>044B50075SIF</b>
				SILICONE USP-121	<b>044B50075SI121</b>
1"	50,40	58,00	1.4404	FPM/FKM	<b>044B60100V</b>
				EPDM	<b>044B60100EP</b>
				SILICONE FDA	<b>044B60100SIF</b>
				SILICONE USP-121	<b>044B60100SI121</b>
			1.4435-BN2	FPM/FKM	<b>044B50100V</b>
				EPDM	<b>044B50100EP</b>
				SILICONE FDA	<b>044B50100SIF</b>
				SILICONE USP-121	<b>044B50100SI121</b>
1.1/2"	50,40	58,00	1.4404	FPM/FKM	<b>044B60150V</b>
				EPDM	<b>044B60150EP</b>
				SILICONE FDA	<b>044B60150SIF</b>
				SILICONE USP-121	<b>044B60150SI121</b>
			1.4435-BN2	FPM/FKM	<b>044B50150V</b>
				EPDM	<b>044B50150EP</b>
				SILICONE FDA	<b>044B50150SIF</b>
				SILICONE USP-121	<b>044B50150SI121</b>

Part list

ASTM A270: Ø A 25	DIN / ISO: Ø A 34	ASTM A270 / DIN / ISO: Ø A 50	N°	Name	Material
			1	Body	AISI 316L
			2	O-Ring 3021	FPM/FKM or EPDM or SILICONE
			3	Piston	AISI 316L
			4	O-Ring 2037	FPM/FKM or EPDM or SILICONE
			5	Ring	AISI 316L
			6	Grub Screw M4	AISI 304
			7	Handle	PTFE + INOX

DIN 32676 - Tri-Clamp

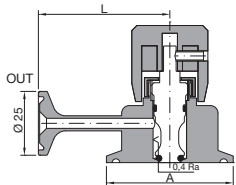
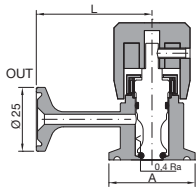

Size	Ø A	L	Valve Material	O-Rings Material	Code
DN 10	34,00	51,50	1.4404	FPM/FKM	044B6D010V
				EPDM	044B6D010EP
				SILICONE FDA	044B6D010SIF
				SILICONE USP-121	044B6D010SI121
			1.4435-BN2	FPM/FKM	044B5D010V
				EPDM	044B5D010EP
				SILICONE FDA	044B5D010SIF
				SILICONE USP-121	044B5D010SI121
DN 15	34,00	51,50	1.4404	FPM/FKM	044B6D015V
				EPDM	044B6D015EP
				SILICONE FDA	044B6D015SIF
				SILICONE USP-121	044B6D015SI121
			1.4435-BN2	FPM/FKM	044B5D015V
				EPDM	044B5D015EP
				SILICONE FDA	044B5D015SIF
				SILICONE USP-121	044B5D015SI121
DN 20	34,00	51,50	1.4404	FPM/FKM	044B6D020V
				EPDM	044B6D020EP
				SILICONE FDA	044B6D020SIF
				SILICONE USP-121	044B6D020SI121
			1.4435-BN2	FPM/FKM	044B5D020V
				EPDM	044B5D020EP
				SILICONE FDA	044B5D020SIF
				SILICONE USP-121	044B5D020SI121
DN 25	50,50	58,00	1.4404	FPM/FKM	044B6D025V
				EPDM	044B6D025EP
				SILICONE FDA	044B6D025SIF
				SILICONE USP-121	044B6D025SI121
			1.4435-BN2	FPM/FKM	044B5D025V
				EPDM	044B5D025EP
				SILICONE FDA	044B5D025SIF
				SILICONE USP-121	044B5D025SI121
DN 32	50,50	58,00	1.4404	FPM/FKM	044B6D032V
				EPDM	044B6D032EP
				SILICONE FDA	044B6D032SIF
				SILICONE USP-121	044B6D032SI121
			1.4435-BN2	FPM/FKM	044B5D032V
				EPDM	044B5D032EP
				SILICONE FDA	044B5D032SIF
				SILICONE USP-121	044B5D032SI121
DN 40	50,50	58,00	1.4404	FPM/FKM	044B6D040V
				EPDM	044B6D040EP
				SILICONE FDA	044B6D040SIF
				SILICONE USP-121	044B6D040SI121
			1.4435-BN2	FPM/FKM	044B5D040V
				EPDM	044B5D040EP
				SILICONE FDA	044B5D040SIF
				SILICONE USP-121	044B5D040SI121

Int. finishing: **Ra ≤ 0,4 µm**  
Ext. finishing: **Ra ≤ 0,8 µm Mirror Polished**

Max Working Conditions:  
**12 bar (170 psi) and 150°C (300°F)**

Installation:  
**Horizontal installation recommended**

ISO 1127 Tri-Clamp

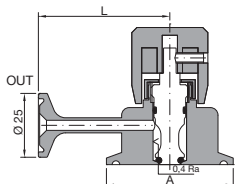
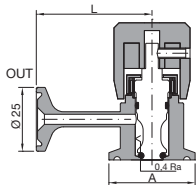

Size	Ø A	L	Valve Material	O-Rings Material	Code
DN 8	34,00	51,50	1.4404	FPM/FKM	044B61008V
				EPDM	044B61008EP
				SILICONE FDA	044B61008SIF
				SILICONE USP-121	044B61008SI121
			1.4435-BN2	FPM/FKM	044B51008V
				EPDM	044B51008EP
				SILICONE FDA	044B51008SIF
				SILICONE USP-121	044B51008SI121
DN 10	34,00	51,50	1.4404	FPM/FKM	044B61010V
				EPDM	044B61010EP
				SILICONE FDA	044B61010SIF
				SILICONE USP-121	044B61010SI121
			1.4435-BN2	FPM/FKM	044B51010V
				EPDM	044B51010EP
				SILICONE FDA	044B51010SIF
				SILICONE USP-121	044B51010SI121
DN 15	34,00	51,50	1.4404	FPM/FKM	044B61015V
				EPDM	044B61015EP
				SILICONE FDA	044B61015SIF
				SILICONE USP-121	044B61015SI121
			1.4435-BN2	FPM/FKM	044B51015V
				EPDM	044B51015EP
				SILICONE FDA	044B51015SIF
				SILICONE USP-121	044B51015SI121
DN 20	50,50	58,00	1.4404	FPM/FKM	044B61020V
				EPDM	044B61020EP
				SILICONE FDA	044B61020SIF
				SILICONE USP-121	044B61020SI121
			1.4435-BN2	FPM/FKM	044B51020V
				EPDM	044B51020EP
				SILICONE FDA	044B51020SIF
				SILICONE USP-121	044B51020SI121
DN 25	50,50	58,00	1.4404	FPM/FKM	044B61025V
				EPDM	044B61025EP
				SILICONE FDA	044B61025SIF
				SILICONE USP-121	044B61025SI121
			1.4435-BN2	FPM/FKM	044B51025V
				EPDM	044B51025EP
				SILICONE FDA	044B51025SIF
				SILICONE USP-121	044B51025SI121
DN 32	50,50	58,00	1.4404	FPM/FKM	044B61032V
				EPDM	044B61032EP
				SILICONE FDA	044B61032SIF
				SILICONE USP-121	044B61032SI121
			1.4435-BN2	FPM/FKM	044B51032V
				EPDM	044B51032EP
				SILICONE FDA	044B51032SIF
				SILICONE USP-121	044B51032SI121

Int. finishing: **Ra ≤ 0,4 µm**  
Ext. finishing: **Ra ≤ 0,8 µm Mirror Polished**

Max Working Conditions:  
**12 bar (170 psi) and 150°C (300°F)**

Installation:  
**Horizontal installation recommended**

ASTM A270 Tri-Clamp - Flange design according to ASME-BPE 2009

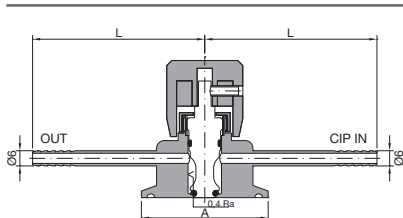
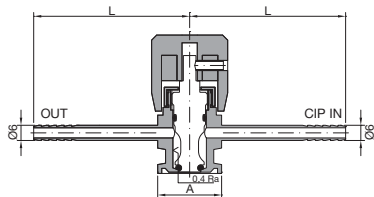

Int. finishing:  $Ra \leq 0,4 \mu m$   
 Ext. finishing:  $Ra \leq 0,8 \mu m$  Mirror Polished  
 Max Working Conditions:  
**12 bar (170 psi) and 150°C (300°F)**  
 Installation:  
**Horizontal installation recommended**

Size	Ø A	L	Valve Material	O-Rings Material	Code
1/2"	25,00	61,50	1.4404	FPM/FKM	044C60050V
				EPDM	044C60050EP
				SILICONE FDA	044C60050SIF
				SILICONE USP-121	044C60050SI121
			1.4435-BN2	FPM/FKM	044C50050V
				EPDM	044C50050EP
				SILICONE FDA	044C50050SIF
				SILICONE USP-121	044C50050SI121
3/4"	25,00	61,50	1.4404	FPM/FKM	044C60075V
				EPDM	044C60075EP
				SILICONE FDA	044C60075SIF
				SILICONE USP-121	044C60075SI121
			1.4435-BN2	FPM/FKM	044C50075V
				EPDM	044C50075EP
				SILICONE FDA	044C50075SIF
				SILICONE USP-121	044C50075SI121
1"	50,40	68,00	1.4404	FPM/FKM	044C60100V
				EPDM	044C60100EP
				SILICONE FDA	044C60100SIF
				SILICONE USP-121	044C60100SI121
			1.4435-BN2	FPM/FKM	044C50100V
				EPDM	044C50100EP
				SILICONE FDA	044C50100SIF
				SILICONE USP-121	044C50100SI121
1.1/2"	50,40	68,00	1.4404	FPM/FKM	044C60150V
				EPDM	044C60150EP
				SILICONE FDA	044C60150SIF
				SILICONE USP-121	044C60150SI121
			1.4435-BN2	FPM/FKM	044C50150V
				EPDM	044C50150EP
				SILICONE FDA	044C50150SIF
				SILICONE USP-121	044C50150SI121

Part list

ASTM A270: Ø A 25	DIN / ISO: Ø A 34	ASTM A270 / DIN / ISO: Ø A 50	N°	Name	Material
			1	Body	AISI 316L
			2	O-Ring 3021	FPM/FKM or EPDM or SILICONE
			3	Piston	AISI 316L
			4	O-Ring 2037	FPM/FKM or EPDM or SILICONE
			5	Ring	AISI 316L
			6	Grub Screw M4	AISI 304
			7	Handle	PTFE + INOX



DIN 32676 - Tri-Clamp

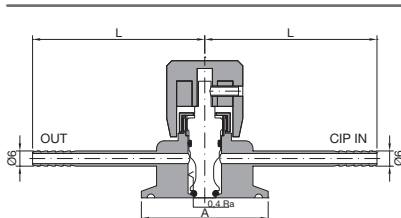
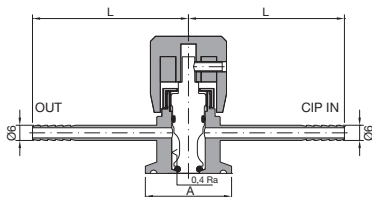

Size	Ø A	L	Valve Material	O-Rings Material	Code
DN 10	34,00	61,50	1.4404	FPM/FKM	044C6D010V
				EPDM	044C6D010EP
				SILICONE FDA	044C6D010SIF
				SILICONE USP-121	044C6D010SI121
			1.4435-BN2	FPM/FKM	044C5D010V
				EPDM	044C5D010EP
				SILICONE FDA	044C5D010SIF
				SILICONE USP-121	044C5D010SI121
DN 15	34,00	61,50	1.4404	FPM/FKM	044C6D015V
				EPDM	044C6D015EP
				SILICONE FDA	044C6D015SIF
				SILICONE USP-121	044C6D015SI121
			1.4435-BN2	FPM/FKM	044C5D015V
				EPDM	044C5D015EP
				SILICONE FDA	044C5D015SIF
				SILICONE USP-121	044C5D015SI121
DN 20	34,00	61,50	1.4404	FPM/FKM	044C6D020V
				EPDM	044C6D020EP
				SILICONE FDA	044C6D020SIF
				SILICONE USP-121	044C6D020SI121
			1.4435-BN2	FPM/FKM	044C5D020V
				EPDM	044C5D020EP
				SILICONE FDA	044C5D020SIF
				SILICONE USP-121	044C5D020SI121
DN 25	50,50	68,00	1.4404	FPM/FKM	044C6D025V
				EPDM	044C6D025EP
				SILICONE FDA	044C6D025SIF
				SILICONE USP-121	044C6D025SI121
			1.4435-BN2	FPM/FKM	044C5D025V
				EPDM	044C5D025EP
				SILICONE FDA	044C5D025SIF
				SILICONE USP-121	044C5D025SI121
DN 32	50,50	68,00	1.4404	FPM/FKM	044C6D032V
				EPDM	044C6D032EP
				SILICONE FDA	044C6D032SIF
				SILICONE USP-121	044C6D032SI121
			1.4435-BN2	FPM/FKM	044C5D032V
				EPDM	044C5D032EP
				SILICONE FDA	044C5D032SIF
				SILICONE USP-121	044C5D032SI121
DN 40	50,50	68,00	1.4404	FPM/FKM	044C6D040V
				EPDM	044C6D040EP
				SILICONE FDA	044C6D040SIF
				SILICONE USP-121	044C6D040SI121
			1.4435-BN2	FPM/FKM	044C5D040V
				EPDM	044C5D040EP
				SILICONE FDA	044C5D040SIF
				SILICONE USP-121	044C5D040SI121

Int. finishing: **Ra ≤ 0,4 µm**  
Ext. finishing: **Ra ≤ 0,8 µm Mirror Polished**

Max Working Conditions:  
**12 bar (170 psi) and 150°C (300°F)**

Installation:  
**Horizontal installation recommended**

ISO 1127 Tri-Clamp

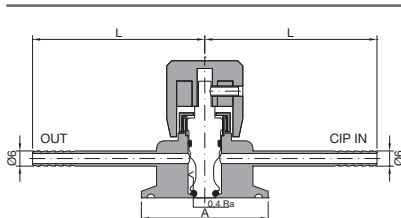
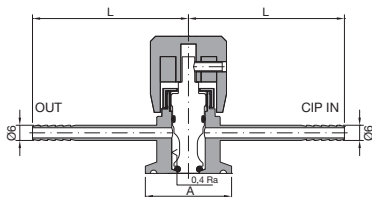

Size	Ø A	L	Valve Material	O-Rings Material	Code
DN 8	34,00	61,50	1.4404	FPM/FKM	044C61008V
				EPDM	044C61008EP
				SILICONE FDA	044C61008SIF
				SILICONE USP-121	044C61008SH121
			1.4435-BN2	FPM/FKM	044C51008V
				EPDM	044C51008EP
				SILICONE FDA	044C51008SIF
				SILICONE USP-121	044C51008SH121
DN 10	34,00	61,50	1.4404	FPM/FKM	044C61010V
				EPDM	044C61010EP
				SILICONE FDA	044C61010SIF
				SILICONE USP-121	044C61010SH121
			1.4435-BN2	FPM/FKM	044C51010V
				EPDM	044C51010EP
				SILICONE FDA	044C51010SIF
				SILICONE USP-121	044C51010SH121
DN 15	34,00	61,50	1.4404	FPM/FKM	044C61015V
				EPDM	044C61015EP
				SILICONE FDA	044C61015SIF
				SILICONE USP-121	044C61015SH121
			1.4435-BN2	FPM/FKM	044C51015V
				EPDM	044C51015EP
				SILICONE FDA	044C51015SIF
				SILICONE USP-121	044C51015SH121
DN 20	50,50	68,00	1.4404	FPM/FKM	044C61020V
				EPDM	044C61020EP
				SILICONE FDA	044C61020SIF
				SILICONE USP-121	044C61020SH121
			1.4435-BN2	FPM/FKM	044C51020V
				EPDM	044C51020EP
				SILICONE FDA	044C51020SIF
				SILICONE USP-121	044C51020SH121
DN 25	50,50	68,00	1.4404	FPM/FKM	044C61025V
				EPDM	044C61025EP
				SILICONE FDA	044C61025SIF
				SILICONE USP-121	044C61025SH121
			1.4435-BN2	FPM/FKM	044C51025V
				EPDM	044C51025EP
				SILICONE FDA	044C51025SIF
				SILICONE USP-121	044C51025SH121
DN 32	50,50	68,00	1.4404	FPM/FKM	044C61032V
				EPDM	044C61032EP
				SILICONE FDA	044C61032SIF
				SILICONE USP-121	044C61032SH121
			1.4435-BN2	FPM/FKM	044C51032V
				EPDM	044C51032EP
				SILICONE FDA	044C51032SIF
				SILICONE USP-121	044C51032SH121

Int. finishing: **Ra ≤ 0,4 µm**  
Ext. finishing: **Ra ≤ 0,8 µm Mirror Polished**

Max Working Conditions:  
**12 bar (170 psi) and 150°C (300°F)**

Installation:  
**Horizontal installation recommended**

ASTM A270 Tri-Clamp - Flange design according to ASME-BPE 2009

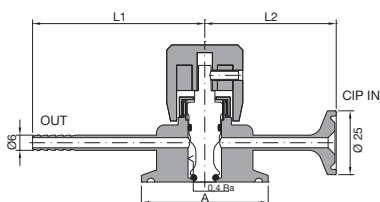
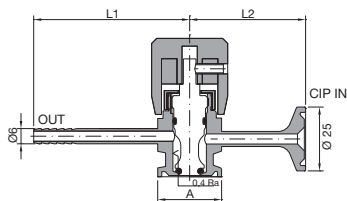

Int. finishing:  $Ra \leq 0,4 \mu m$   
Ext. finishing:  $Ra \leq 0,8 \mu m$  Mirror Polished

Max Working Conditions:  
12 bar (170 psi) and 150°C (300°F)

Installation:  
Horizontal installation recommended

Size	Ø A	L 1	L 2	Valve Material	O-Rings Material	Code
1/2"	25,00	61,50	51,50	1.4404	FPM/FKM	044D60050V
					EPDM	044D60050EP
					SILICONE FDA	044D60050SIF
					SILICONE USP-121	044D60050SI121
				1.4435-BN2	FPM/FKM	044D50050V
					EPDM	044D50050EP
					SILICONE FDA	044D50050SIF
					SILICONE USP-121	044D50050SI121
3/4"	25,00	61,50	51,50	1.4404	FPM/FKM	044D60075V
					EPDM	044D60075EP
					SILICONE FDA	044D60075SIF
					SILICONE USP-121	044D60075SI121
				1.4435-BN2	FPM/FKM	044D50075V
					EPDM	044D50075EP
					SILICONE FDA	044D50075SIF
					SILICONE USP-121	044D50075SI121
1"	50,40	68,00	58,00	1.4404	FPM/FKM	044D60100V
					EPDM	044D60100EP
					SILICONE FDA	044D60100SIF
					SILICONE USP-121	044D60100SI121
				1.4435-BN2	FPM/FKM	044D50100V
					EPDM	044D50100EP
					SILICONE FDA	044D50100SIF
					SILICONE USP-121	044D50100SI121
1.1/2"	50,40	68,00	58,00	1.4404	FPM/FKM	044D60150V
					EPDM	044D60150EP
					SILICONE FDA	044D60150SIF
					SILICONE USP-121	044D60150SI121
				1.4435-BN2	FPM/FKM	044D50150V
					EPDM	044D50150EP
					SILICONE FDA	044D50150SIF
					SILICONE USP-121	044D50150SI121

Part list

ASTM A270: Ø A 25	DIN / ISO: Ø A 34	ASTM A270 / DIN / ISO: Ø A 50	N°	Name	Material
			1	Body	AISI 316L
			2	O-Ring 3021	FPM/FKM or EPDM or SILICONE
			3	Piston	AISI 316L
			4	O-Ring 2037	FPM/FKM or EPDM or SILICONE
			5	Ring	AISI 316L
			6	Grub Screw M4	AISI 304
			7	Handle	PTFE + INOX

DIN 32676 - Tri-Clamp

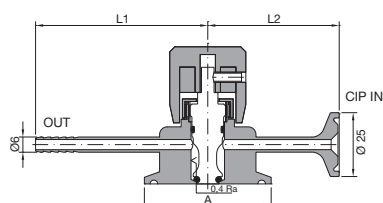
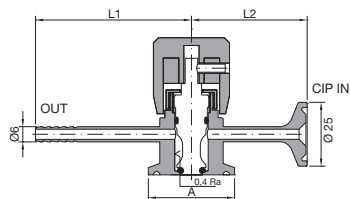

Size	Ø A	L 1	L 2	Valve Material	O-Rings Material	Code
DN 10	34,00	61,50	51,50	1.4404	FPM/FKM	044D6D010V
					EPDM	044D6D010EP
					SILICONE FDA	044D6D010SIF
					SILICONE USP-121	044D6D010Si121
				1.4435-BN2	FPM/FKM	044D5D010V
					EPDM	044D5D010EP
					SILICONE FDA	044D5D010SIF
					SILICONE USP-121	044D5D010Si121
DN 15	34,00	61,50	51,50	1.4404	FPM/FKM	044D6D015V
					EPDM	044D6D015EP
					SILICONE FDA	044D6D015SIF
					SILICONE USP-121	044D6D015Si121
				1.4435-BN2	FPM/FKM	044D5D015V
					EPDM	044D5D015EP
					SILICONE FDA	044D5D015SIF
					SILICONE USP-121	044D5D015Si121
DN 20	34,00	61,50	51,50	1.4404	FPM/FKM	044D6D020V
					EPDM	044D6D020EP
					SILICONE FDA	044D6D020SIF
					SILICONE USP-121	044D6D020Si121
				1.4435-BN2	FPM/FKM	044D5D020V
					EPDM	044D5D020EP
					SILICONE FDA	044D5D020SIF
					SILICONE USP-121	044D5D020Si121
DN 25	50,50	68,00	58,00	1.4404	FPM/FKM	044D6D025V
					EPDM	044D6D025EP
					SILICONE FDA	044D6D025SIF
					SILICONE USP-121	044D6D025Si121
				1.4435-BN2	FPM/FKM	044D5D025V
					EPDM	044D5D025EP
					SILICONE FDA	044D5D025SIF
					SILICONE USP-121	044D5D025Si121
DN 32	50,50	68,00	58,00	1.4404	FPM/FKM	044D6D032V
					EPDM	044D6D032EP
					SILICONE FDA	044D6D032SIF
					SILICONE USP-121	044D6D032Si121
				1.4435-BN2	FPM/FKM	044D5D032V
					EPDM	044D5D032EP
					SILICONE FDA	044D5D032SIF
					SILICONE USP-121	044D5D032Si121
DN 40	50,50	68,00	58,00	1.4404	FPM/FKM	044D6D040V
					EPDM	044D6D040EP
					SILICONE FDA	044D6D040SIF
					SILICONE USP-121	044D6D040Si121
				1.4435-BN2	FPM/FKM	044D5D040V
					EPDM	044D5D040EP
					SILICONE FDA	044D5D040SIF
					SILICONE USP-121	044D5D040Si121

Int. finishing: **Ra ≤ 0,4 µm**  
Ext. finishing: **Ra ≤ 0,8 µm Mirror Polished**

Max Working Conditions:  
**12 bar (170 psi) and 150°C (300°F)**

Installation:  
**Horizontal installation recommended**

ISO 1127 Tri-Clamp

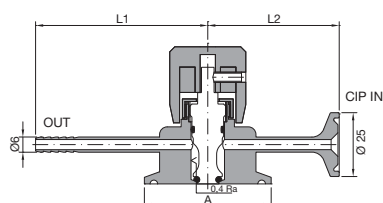
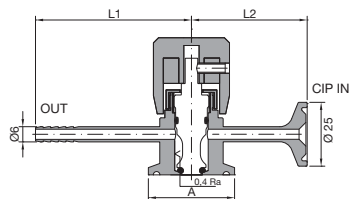

Size	Ø A	L 1	L 2	Valve Material	O-Rings Material	Code
DN 8	34,00	61,50	51,50	1.4404	FPM/FKM	044D61008V
					EPDM	044D61008EP
					SILICONE FDA	044D61008SIF
					SILICONE USP-121	044D61008SH121
				1.4435-BN2	FPM/FKM	044D51008V
					EPDM	044D51008EP
					SILICONE FDA	044D51008SIF
					SILICONE USP-121	044D51008SH121
DN 10	34,00	61,50	51,50	1.4404	FPM/FKM	044D61010V
					EPDM	044D61010EP
					SILICONE FDA	044D61010SIF
					SILICONE USP-121	044D61010SH121
				1.4435-BN2	FPM/FKM	044D51010V
					EPDM	044D51010EP
					SILICONE FDA	044D51010SIF
					SILICONE USP-121	044D51010SH121
DN 15	34,00	61,50	51,50	1.4404	FPM/FKM	044D61015V
					EPDM	044D61015EP
					SILICONE FDA	044D61015SIF
					SILICONE USP-121	044D61015SH121
				1.4435-BN2	FPM/FKM	044D51015V
					EPDM	044D51015EP
					SILICONE FDA	044D51015SIF
					SILICONE USP-121	044D51015SH121
DN 20	50,50	68,00	58,00	1.4404	FPM/FKM	044D61020V
					EPDM	044D61020EP
					SILICONE FDA	044D61020SIF
					SILICONE USP-121	044D61020SH121
				1.4435-BN2	FPM/FKM	044D51020V
					EPDM	044D51020EP
					SILICONE FDA	044D51020SIF
					SILICONE USP-121	044D51020SH121
DN 25	50,50	68,00	58,00	1.4404	FPM/FKM	044D61025V
					EPDM	044D61025EP
					SILICONE FDA	044D61025SIF
					SILICONE USP-121	044D61025SH121
				1.4435-BN2	FPM/FKM	044D51025V
					EPDM	044D51025EP
					SILICONE FDA	044D51025SIF
					SILICONE USP-121	044D51025SH121
DN 32	50,50	68,00	58,00	1.4404	FPM/FKM	044D61032V
					EPDM	044D61032EP
					SILICONE FDA	044D61032SIF
					SILICONE USP-121	044D61032SH121
				1.4435-BN2	FPM/FKM	044D51032V
					EPDM	044D51032EP
					SILICONE FDA	044D51032SIF
					SILICONE USP-121	044D51032SH121

Int. finishing: **Ra ≤ 0,4 µm**  
Ext. finishing: **Ra ≤ 0,8 µm Mirror Polished**

Max Working Conditions:  
**12 bar (170 psi) and 150°C (300°F)**

Installation:  
**Horizontal installation recommended**

ASTM A270 Tri-Clamp - Flange design according to ASME-BPE 2009

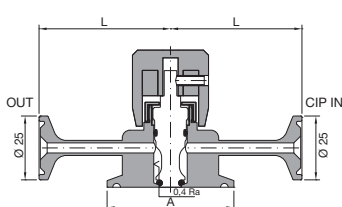
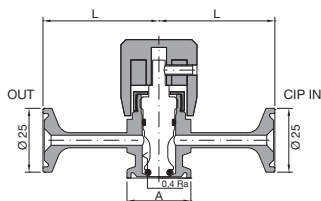

Int. finishing:  $Ra \leq 0,4 \mu m$   
Ext. finishing:  $Ra \leq 0,8 \mu m$  Mirror Polished

Max Working Conditions:  
12 bar (170 psi) and 150°C (300°F)

Installation:  
Horizontal installation recommended

Size	Ø A	L	Valve Material	O-Rings Material	Code
1/2"	25,00	51,50	1.4404	FPM/FKM	044E60050V
				EPDM	044E60050EP
				SILICONE FDA	044E60050SIF
				SILICONE USP-121	044E60050SH121
			1.4435-BN2	FPM/FKM	044E50050V
				EPDM	044E50050EP
				SILICONE FDA	044E50050SIF
				SILICONE USP-121	044E50050SH121
3/4"	25,00	51,50	1.4404	FPM/FKM	044E60075V
				EPDM	044E60075EP
				SILICONE FDA	044E60075SIF
				SILICONE USP-121	044E60075SH121
			1.4435-BN2	FPM/FKM	044E50075V
				EPDM	044E50075EP
				SILICONE FDA	044E50075SIF
				SILICONE USP-121	044E50075SH121
1"	50,40	58,00	1.4404	FPM/FKM	044E60100V
				EPDM	044E60100EP
				SILICONE FDA	044E60100SIF
				SILICONE USP-121	044E60100SH121
			1.4435-BN2	FPM/FKM	044E50100V
				EPDM	044E50100EP
				SILICONE FDA	044E50100SIF
				SILICONE USP-121	044E50100SH121
1.1/2"	50,40	58,00	1.4404	FPM/FKM	044E60150V
				EPDM	044E60150EP
				SILICONE FDA	044E60150SIF
				SILICONE USP-121	044E60150SH121
			1.4435-BN2	FPM/FKM	044E50150V
				EPDM	044E50150EP
				SILICONE FDA	044E50150SIF
				SILICONE USP-121	044E50150SH121

Part list

ASTM A270: Ø A 25	DIN / ISO: Ø A 34	ASTM A270 / DIN / ISO: Ø A 50	N°	Name	Material
			1	Body	AISI 316L
			2	O-Ring 3021	FPM/FKM or EPDM or SILICONE
			3	Piston	AISI 316L
			4	O-Ring 2037	FPM/FKM or EPDM or SILICONE
			5	Ring	AISI 316L
			6	Grub Screw M4	AISI 304
			7	Handle	PTFE + INOX

DIN 32676 - Tri-Clamp

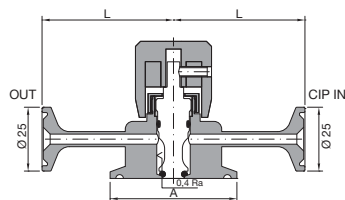
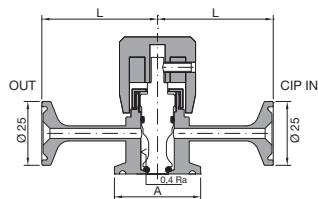

Size	Ø A	L	Valve Material	O-Rings Material	Code
DN 10	34,00	51,50	1.4404	FPM/FKM	044E6D010V
				EPDM	044E6D010EP
				SILICONE FDA	044E6D010SIF
				SILICONE USP-121	044E6D010SI121
			1.4435-BN2	FPM/FKM	044E5D010V
				EPDM	044E5D010EP
				SILICONE FDA	044E5D010SIF
				SILICONE USP-121	044E5D010SI121
DN 15	34,00	51,50	1.4404	FPM/FKM	044E6D015V
				EPDM	044E6D015EP
				SILICONE FDA	044E6D015SIF
				SILICONE USP-121	044E6D015SI121
			1.4435-BN2	FPM/FKM	044E5D015V
				EPDM	044E5D015EP
				SILICONE FDA	044E5D015SIF
				SILICONE USP-121	044E5D015SI121
DN 20	34,00	51,50	1.4404	FPM/FKM	044E6D020V
				EPDM	044E6D020EP
				SILICONE FDA	044E6D020SIF
				SILICONE USP-121	044E6D020SI121
			1.4435-BN2	FPM/FKM	044E5D020V
				EPDM	044E5D020EP
				SILICONE FDA	044E5D020SIF
				SILICONE USP-121	044E5D020SI121
DN 25	50,50	58,00	1.4404	FPM/FKM	044E6D025V
				EPDM	044E6D025EP
				SILICONE FDA	044E6D025SIF
				SILICONE USP-121	044E6D025SI121
			1.4435-BN2	FPM/FKM	044E5D025V
				EPDM	044E5D025EP
				SILICONE FDA	044E5D025SIF
				SILICONE USP-121	044E5D025SI121
DN 32	50,50	58,00	1.4404	FPM/FKM	044E6D032V
				EPDM	044E6D032EP
				SILICONE FDA	044E6D032SIF
				SILICONE USP-121	044E6D032SI121
			1.4435-BN2	FPM/FKM	044E5D032V
				EPDM	044E5D032EP
				SILICONE FDA	044E5D032SIF
				SILICONE USP-121	044E5D032SI121
DN 40	50,50	58,00	1.4404	FPM/FKM	044E6D040V
				EPDM	044E6D040EP
				SILICONE FDA	044E6D040SIF
				SILICONE USP-121	044E6D040SI121
			1.4435-BN2	FPM/FKM	044E5D040V
				EPDM	044E5D040EP
				SILICONE FDA	044E5D040SIF
				SILICONE USP-121	044E5D040SI121

Int. finishing: **Ra ≤ 0,4 µm**  
Ext. finishing: **Ra ≤ 0,8 µm Mirror Polished**

Max Working Conditions:  
**12 bar (170 psi) and 150°C (300°F)**

Installation:  
**Horizontal installation recommended**

ISO 1127 Tri-Clamp

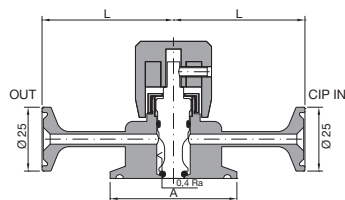
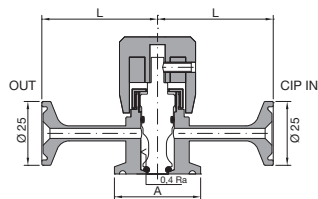

Size	Ø A	L	Valve Material	O-Rings Material	Code
DN 8	34,00	51,50	1.4404	FPM/FKM	044E61008V
				EPDM	044E61008EP
				SILICONE FDA	044E61008SIF
				SILICONE USP-121	044E61008SI121
			1.4435-BN2	FPM/FKM	044E51008V
				EPDM	044E51008EP
				SILICONE FDA	044E51008SIF
				SILICONE USP-121	044E51008SI121
DN 10	34,00	51,50	1.4404	FPM/FKM	044E61010V
				EPDM	044E61010EP
				SILICONE FDA	044E61010SIF
				SILICONE USP-121	044E61010SI121
			1.4435-BN2	FPM/FKM	044E51010V
				EPDM	044E51010EP
				SILICONE FDA	044E51010SIF
				SILICONE USP-121	044E51010SI121
DN 15	34,00	51,50	1.4404	FPM/FKM	044E61015V
				EPDM	044E61015EP
				SILICONE FDA	044E61015SIF
				SILICONE USP-121	044E61015SI121
			1.4435-BN2	FPM/FKM	044E51015V
				EPDM	044E51015EP
				SILICONE FDA	044E51015SIF
				SILICONE USP-121	044E51015SI121
DN 20	50,50	58,00	1.4404	FPM/FKM	044E61020V
				EPDM	044E61020EP
				SILICONE FDA	044E61020SIF
				SILICONE USP-121	044E61020SI121
			1.4435-BN2	FPM/FKM	044E51020V
				EPDM	044E51020EP
				SILICONE FDA	044E51020SIF
				SILICONE USP-121	044E51020SI121
DN 25	50,50	58,00	1.4404	FPM/FKM	044E61025V
				EPDM	044E61025EP
				SILICONE FDA	044E61025SIF
				SILICONE USP-121	044E61025SI121
			1.4435-BN2	FPM/FKM	044E51025V
				EPDM	044E51025EP
				SILICONE FDA	044E51025SIF
				SILICONE USP-121	044E51025SI121
DN 32	50,50	58,00	1.4404	FPM/FKM	044E61032V
				EPDM	044E61032EP
				SILICONE FDA	044E61032SIF
				SILICONE USP-121	044E61032SI121
			1.4435-BN2	FPM/FKM	044E51032V
				EPDM	044E51032EP
				SILICONE FDA	044E51032SIF
				SILICONE USP-121	044E51032SI121

Int. finishing: **Ra ≤ 0,4 µm**  
Ext. finishing: **Ra ≤ 0,8 µm Mirror Polished**

Max Working Conditions:  
**12 bar (170 psi) and 150°C (300°F)**

Installation:  
**Horizontal installation recommended**



ASTM A270 Tri-Clamp - Flange design according to ASME-BPE 2009

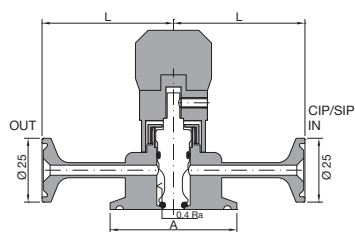
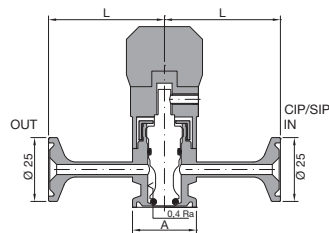

Int. finishing:  $Ra \leq 0,4 \mu m$   
Ext. finishing:  $Ra \leq 0,8 \mu m$  Mirror Polished

Max Working Conditions:  
**12 bar (170 psi) and 150°C (300°F)**

Installation:  
**Horizontal installation recommended**

Size	Ø A	L	Valve Material	O-Rings Material	Code
1/2"	25,00	51,50	1.4404	FPM/FKM	044F60050V
				EPDM	044F60050EP
				SILICONE FDA	044F60050SIF
				SILICONE USP-121	044F60050SH121
			1.4435-BN2	FPM/FKM	044F50050V
				EPDM	044F50050EP
				SILICONE FDA	044F50050SIF
				SILICONE USP-121	044F50050SH121
3/4"	25,00	51,50	1.4404	FPM/FKM	044F60075V
				EPDM	044F60075EP
				SILICONE FDA	044F60075SIF
				SILICONE USP-121	044F60075SH121
			1.4435-BN2	FPM/FKM	044F50075V
				EPDM	044F50075EP
				SILICONE FDA	044F50075SIF
				SILICONE USP-121	044F50075SH121
1"	50,40	58,00	1.4404	FPM/FKM	044F60100V
				EPDM	044F60100EP
				SILICONE FDA	044F60100SIF
				SILICONE USP-121	044F60100SH121
			1.4435-BN2	FPM/FKM	044F50100V
				EPDM	044F50100EP
				SILICONE FDA	044F50100SIF
				SILICONE USP-121	044F50100SH121
1.1/2"	50,40	58,00	1.4404	FPM/FKM	044F60150V
				EPDM	044F60150EP
				SILICONE FDA	044F60150SIF
				SILICONE USP-121	044F60150SH121
			1.4435-BN2	FPM/FKM	044F50150V
				EPDM	044F50150EP
				SILICONE FDA	044F50150SIF
				SILICONE USP-121	044F50150SH121

Part list

ASTM A270: Ø A 25	DIN / ISO: Ø A 34	ASTM A270 / DIN / ISO: Ø A 50	N°	Name	Material
			1	Body	AISI 316L
			2	O-Ring 3021	FPM/FKM or EPDM or SILICONE
			3	Piston	AISI 316L
			4	O-Ring 2037	FPM/FKM or EPDM or SILICONE
			5	Ring	AISI 316L
			6	Grub Screw M4	AISI 304
			7	Removable Handle	PTFE + INOX

DIN 32676 - Tri-Clamp

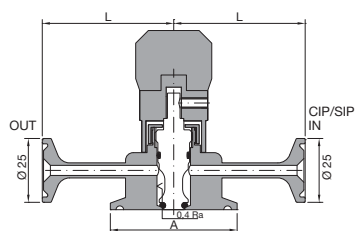
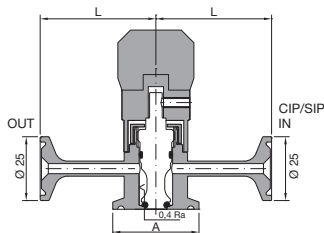

Size	Ø A	L	Valve Material	O-Rings Material	Code
DN 10	34,00	51,50	1.4404	FPM/FKM	044F6D010V
				EPDM	044F6D010EP
				SILICONE FDA	044F6D010SIF
				SILICONE USP-121	044F6D010SI121
			1.4435-BN2	FPM/FKM	044F5D010V
				EPDM	044F5D010EP
				SILICONE FDA	044F5D010SIF
				SILICONE USP-121	044F5D010SI121
DN 15	34,00	51,50	1.4404	FPM/FKM	044F6D015V
				EPDM	044F6D015EP
				SILICONE FDA	044F6D015SIF
				SILICONE USP-121	044F6D015SI121
			1.4435-BN2	FPM/FKM	044F5D015V
				EPDM	044F5D015EP
				SILICONE FDA	044F5D015SIF
				SILICONE USP-121	044F5D015SI121
DN 20	34,00	51,50	1.4404	FPM/FKM	044F6D020V
				EPDM	044F6D020EP
				SILICONE FDA	044F6D020SIF
				SILICONE USP-121	044F6D020SI121
			1.4435-BN2	FPM/FKM	044F5D020V
				EPDM	044F5D020EP
				SILICONE FDA	044F5D020SIF
				SILICONE USP-121	044F5D020SI121
DN 25	50,50	58,00	1.4404	FPM/FKM	044F6D025V
				EPDM	044F6D025EP
				SILICONE FDA	044F6D025SIF
				SILICONE USP-121	044F6D025SI121
			1.4435-BN2	FPM/FKM	044F5D025V
				EPDM	044F5D025EP
				SILICONE FDA	044F5D025SIF
				SILICONE USP-121	044F5D025SI121
DN 32	50,50	58,00	1.4404	FPM/FKM	044F6D032V
				EPDM	044F6D032EP
				SILICONE FDA	044F6D032SIF
				SILICONE USP-121	044F6D032SI121
			1.4435-BN2	FPM/FKM	044F5D032V
				EPDM	044F5D032EP
				SILICONE FDA	044F5D032SIF
				SILICONE USP-121	044F5D032SI121
DN 40	50,50	58,00	1.4404	FPM/FKM	044F6D040V
				EPDM	044F6D040EP
				SILICONE FDA	044F6D040SIF
				SILICONE USP-121	044F6D040SI121
			1.4435-BN2	FPM/FKM	044F5D040V
				EPDM	044F5D040EP
				SILICONE FDA	044F5D040SIF
				SILICONE USP-121	044F5D040SI121

Int. finishing: **Ra ≤ 0,4 µm**  
Ext. finishing: **Ra ≤ 0,8 µm Mirror Polished**

Max Working Conditions:  
**12 bar (170 psi) and 150°C (300°F)**

Installation:  
**Horizontal installation recommended**

ISO 1127 Tri-Clamp

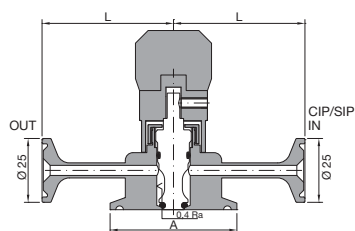
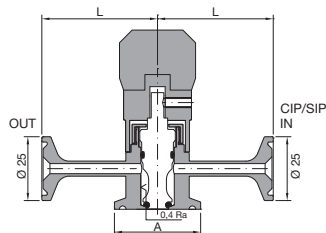

Size	Ø A	L	Valve Material	O-Rings Material	Code
DN 8	34,00	51,50	1.4404	FPM/FKM	044F61008V
				EPDM	044F61008EP
				SILICONE FDA	044F61008SIF
				SILICONE USP-121	044F61008SI121
			1.4435-BN2	FPM/FKM	044F51008V
				EPDM	044F51008EP
				SILICONE FDA	044F51008SIF
				SILICONE USP-121	044F51008SI121
DN 10	34,00	51,50	1.4404	FPM/FKM	044F61010V
				EPDM	044F61010EP
				SILICONE FDA	044F61010SIF
				SILICONE USP-121	044F61010SI121
			1.4435-BN2	FPM/FKM	044F51010V
				EPDM	044F51010EP
				SILICONE FDA	044F51010SIF
				SILICONE USP-121	044F51010SI121
DN 15	34,00	51,50	1.4404	FPM/FKM	044F61015V
				EPDM	044F61015EP
				SILICONE FDA	044F61015SIF
				SILICONE USP-121	044F61015SI121
			1.4435-BN2	FPM/FKM	044F51015V
				EPDM	044F51015EP
				SILICONE FDA	044F51015SIF
				SILICONE USP-121	044F51015SI121
DN 20	50,50	58,00	1.4404	FPM/FKM	044F61020V
				EPDM	044F61020EP
				SILICONE FDA	044F61020SIF
				SILICONE USP-121	044F61020SI121
			1.4435-BN2	FPM/FKM	044F51020V
				EPDM	044F51020EP
				SILICONE FDA	044F51020SIF
				SILICONE USP-121	044F51020SI121
DN 25	50,50	58,00	1.4404	FPM/FKM	044F61025V
				EPDM	044F61025EP
				SILICONE FDA	044F61025SIF
				SILICONE USP-121	044F61025SI121
			1.4435-BN2	FPM/FKM	044F51025V
				EPDM	044F51025EP
				SILICONE FDA	044F51025SIF
				SILICONE USP-121	044F51025SI121
DN 32	50,50	58,00	1.4404	FPM/FKM	044F61032V
				EPDM	044F61032EP
				SILICONE FDA	044F61032SIF
				SILICONE USP-121	044F61032SI121
			1.4435-BN2	FPM/FKM	044F51032V
				EPDM	044F51032EP
				SILICONE FDA	044F51032SIF
				SILICONE USP-121	044F51032SI121

Int. finishing: **Ra ≤ 0,4 µm**  
Ext. finishing: **Ra ≤ 0,8 µm Mirror Polished**

Max Working Conditions:  
**12 bar (170 psi) and 150°C (300°F)**

Installation:  
**Horizontal installation recommended**

044/A - 044/B -044/C - 044/D - 044/E - Spare parts

N°	Description	Valve size	Code
2+4	O-Ring Kit 3021 / 2037 FPM/FKM - n° 10 + 10 pcs	all sizes	<b>044ZX000024K1</b>
2+4	O-Ring Kit 3021 / 2037 EPDM - n° 10 + 10 pcs	all sizes	<b>044ZX000024K2</b>
2+4	O-Ring Kit 3021 / 2037 SILICONE FDA - n° 10 + 10 pcs	all sizes	<b>044ZX000024K3</b>
2+4	O-Ring Kit 3021 / 2037 SILICONE USP 121° - n° 10 + 10 pcs	all sizes	<b>044ZX000024K4</b>
5	Ring - n° 1 pcs	all sizes	<b>044Z6000005</b>
6	Grub Screw M4 Kit - n° 10 pcs	all sizes	<b>044Z4000006</b>
7	Handle PTFE + INOX - n° 1 pcs	all sizes	<b>044Z6000007PTF</b>

ASTM A270: Ø A 25	DIN / ISO: Ø A 34	ASTM A270 / DIN / ISO: Ø A 50	N°	Name	Material
			1	Body	AISI 316L
			2	O-Ring 3021	FPM/FKM or EPDM or SILICONE
			3	Piston	AISI 316L
			4	O-Ring 2037	FPM/FKM or EPDM or SILICONE
			5	Ring	AISI 316L
			6	Grub Screw M4	AISI 304
			7	Handle	PTFE + INOX

044/F - Spare parts

N°	Description	Valve size	Code
2+4	O-Ring Kit 3021 / 2037 FPM/FKM - n° 10 + 10 pcs	all sizes	<b>044ZX000024K1</b>
2+4	O-Ring Kit 3021 / 2037 EPDM - n° 10 + 10 pcs	all sizes	<b>044ZX000024K2</b>
2+4	O-Ring Kit 3021 / 2037 SILICONE FDA - n° 10 + 10 pcs	all sizes	<b>044ZX000024K3</b>
2+4	O-Ring Kit 3021 / 2037 SILICONE USP 121° - n° 10 + 10 pcs	all sizes	<b>044ZX000024K4</b>
5	Ring - n° 1 pcs	all sizes	<b>044Z6000005</b>
6	Grub Screw M4 Kit - n° 10 pcs	all sizes	<b>044Z4000006</b>
7	Removable Handle PTFE + INOX - n° 1 pcs	all sizes	<b>044F6000007PTF</b>

ASTM A270: Ø A 25	DIN / ISO: Ø A 34	ASTM A270 / DIN / ISO: Ø A 50	N°	Name	Material
			1	Body	AISI 316L
			2	O-Ring 3021	FPM/FKM or EPDM or SILICONE
			3	Piston	AISI 316L
			4	O-Ring 2037	FPM/FKM or EPDM or SILICONE
			5	Ring	AISI 316L
			6	Grub Screw M4	AISI 304
			7	Removable Handle	PTFE + INOX